



SUBSTATION CONNECTORS

SECTION SF

MISCELLANEOUS AND GROUNDING ALUMINUM CORONA END PLUG FOR ALUMINUM TUBING

| |
|-------------|
| ALUMINUM |
| ACBI |

Aluminum internal, corona end plug for reducing electrostatic loss and enclosing tubing end. Plug is designed for drive fit with tapered internal fingers.

Material: 356-T6 aluminum alloy

Note: To specify extra heavy (schedule 80, EHIPS) tubing, add "H" to catalog number; Example: ACBIH- 12

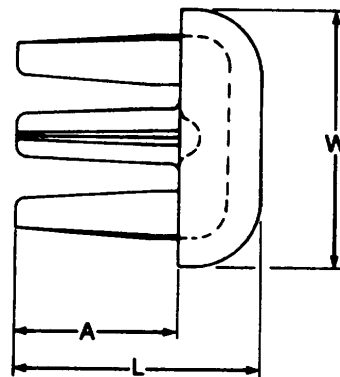
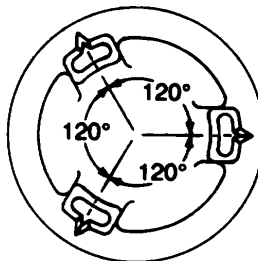
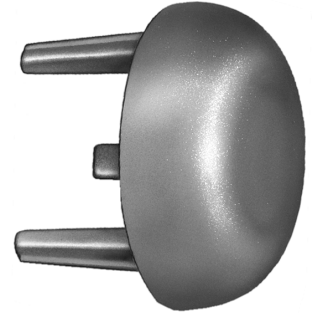

| CATALOG NUMBER | ALUMINUM CONDUCTOR SIZE TUBING IPS | DIMENSIONS INCHES (MM) | | | APPROX. WT. EACH LBS. (KG) |
|----------------|------------------------------------|------------------------|------------------|--------------------|----------------------------|
| | | L | A | W | |
| ACBI-10 | 1 | 1-1/4 (31.75) | 3/4 (19.05) | 1-5/16 (33.34) | .20 (.09) |
| ACBI-12 | 1-1/4 | 1-5/8 (41.27) | 1 (25.4) | 1-11/16 (42.86) | .19 (.09) |
| ACBI-14 | 1-1/2 | 1-3/4 (44.45) | 1-1/4 (31.75) | 1-15/16 (49.21) | .18 (.08) |
| ACBI-20 | 2 | 1-3/4 (44.45) | 1 (25.4) | 2-3/8 (60.32) | .25 (.11) |
| ACBI-24 | 2-1/2 | 2-1/8 (53.98) | 1-1/8 (28.58) | 2-7/8 (73.02) | .46 (.21) |
| ACBI-30 | 3 | 2-1/2 (63.5) | 1-1/4 (31.75) | 3-1/2 (88.9) | .78 (.35) |
| ACBI-34 | 3-1/2 | 2-3/4 (69.85) | 1-1/2 (38.1) | 4 (101.6) | .89 (.40) |
| ACBI-40 | 4 | 3 (76.2) | 1-1/2 (38.1) | 4-1/2 (114.3) | 1.2 (.54) |
| ACBI-50 | 5 | 3-1/4 (82.55) | 1-3/4 (44.45) | 5-9/16 (141.29) | 1.7 (.77) |
| ACBI-60 | 6 | 3-1/4 (82.55) | 1-3/4 (44.45) | 6-5/8 (168.28) | 2.2 (1.0) |

SF-3